

## ROUTINE MAINTENANCE



### Dust Bag Replacement.

- Open the Front Casing by pulling the door latch.
- Hold the top of the dust bag with one hand and with the other pull the bottom of the bag out and down.
- Seal the bag using the flap.
- Fit new bag using both hands to ensure bag is firmly in position.

The vacuum cannot be closed until a new dust bag has been fitted.

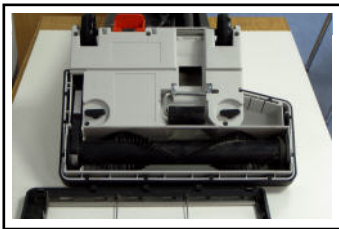

### Belt and Brush Replacement.

- Turn the machine upside down and align the two clips with the front edge of the vacuum.
- Lift off the floor plate and pull brush out, moving brush away from the drive belt.
- Twist the belt to the side of the pulley and remove.
- Refit new belt onto pulley end, put brush through belt, stretching it to replace brush into its housing.
- Replace floor plate.



### Changing the Inlet Filter.

- Remove the dust bag as described above.
  - Twist the filter cage anti-clockwise and lift.
- Replace the filter with a genuine Victor filter and replace filter cage.  
DO NOT USE THE VACUUM WITHOUT AN INLET FILTER



99.99% Filter Efficiency

To upgrade this machine to HEPA standard filtration simply replace the standard inlet filter with a C4018 HEPA Standard Filter Assembly.

We recommend changing this filter with every tenth paper bag fitted.

## VICTOR STANDARD WARRANTY CONDITIONS

With the exception of distributors, this warranty applies to the original purchaser of the product from Dowding and Plummer Ltd.

The product is guaranteed to be, and remain, free from any faults arising from defects in manufacture or materials for a period of one year from date of original purchase.

A discretionary repair or replacement service (inclusive of parts and labour) under the terms of this warranty may only be provided by Dowding and Plummer direct or through a Victor Approved Service Organisation (V.A.S.O.) agent. No payment will be made for a service carried out by any other than those detailed herein.

A warranty registration card is to be completed and returned immediately at time of purchase. Specific limitations and exclusions apply. The return of the Registration Card will denote the customer's acceptance of the warranty conditions.

- **The warranty excludes, but is not limited to:**
  - Product faults that occur due to wear and tear.
  - Damage caused by product misuse and abuse.
  - Normal wear items, cables, belts, filters, skirt hose assemblies, floor tools.
  - Acts of God (lightning flood, etc.)
  - Damage in transit, other than original product delivery.
  - Failure due to lack of proper maintenance or care.
  - Failure to comply with safety information contained herein.

All requests for "under warranty" service must be made to Dowding and Plummer Service Department where Proof of Purchase and / or Guarantee Cards may be required for request to be processed in accordance with the warranty service.

If, after inspection of the returned machine or any part or parts, Dowding & Plummer Ltd determines that the defect is not covered by the warranty, all expenses incurred by Dowding & Plummer in connection with the returned parts shall be the customers responsibility.

In no event will Dowding & Plummer be liable for any indirect, special, incidental, consequential or other losses, inclusive of, but not limited to damage or loss of property or equipment, lost revenues or profits, claims of customers, or harm to goodwill or business reputation directly arising from the sale, handling or use of the machinery supplied, or from any other costs relating thereto and Dowding & Plummer's liability hereunder. Dowding & Plummer shall not be liable to the buyer for any claims, damages, injuries, actions, or causes of action whatsoever based on negligence or strict liability. In addition no representation or warranty, expressed or implied, made by any dealer, sales representative, or field agent of Dowding & Plummer which is not specifically set forth herein shall be binding on Dowding & Plummer.

Dowding & Plummer Ltd, Stockfield Road, Acocks Green, Birmingham B27 6AP  
Tel: 0121 706 5771 Fax: 0121 708 1052 Email: info@victorfloorcare.com

### General

Unplug machine from mains before carrying out any maintenance. Wipe power cable clean after use. Check cable visually for signs of wear and damage. If any is detected, ensure that it is replaced immediately. (see safety instruction).

## OPERATING INSTRUCTION MANUAL

For the

# Victor®

## UPRIGHT CARPET SWEEPER



1. Height Control Knob.
2. Wand.
3. Tool Clip.
4. Door Latch.
5. Warning Light.
6. Bag Full Indicator Light.
7. Power On/Off Switch.
8. Quick Release Cable Clip.
9. Foot Pedal.

**WARNING:** Do not use the appliance without reading the instruction manual.

This appliance is suitable for use in Schools, Hospitals, Hotels, Offices etc.

**CAUTION:** This machine is not suitable for picking up liquids, hazardous dust or flammable materials.

# OPERATING INSTRUCTIONS

## Pre operation checks:

- Inspect power cable and plug for wear or damage.
- Check the brush to ensure no foreign bodies (string, debris etc) are wrapped around brush.
- Ensure the dust bag has been fitted and is in good condition.

## Operate the machine:

- Release cable from the Quick release cable hook by rotating the end piece of the handle and releasing the cable from it's holding restraint. (Fig 5)
- Plug appliance into power supply.
- Adjust brush height (using control knob) to suit the carpet thickness. There are 4 settings. "Hard Floor" for use on hard floor coverings and numbers 1,2 and 3. Setting 1 gives maximum contact with a carpeted floor laying. "Hard Floor" setting is not recommended for use on carpets. (Fig 1.A)
- Press the power switch to the ON position. (Both the vacuum and brush roll motors will start up) (Fig 2.A)
- Hold the handle and depress the Red foot pedal, which will unlock the handle from the upright position and allow the user to lower it to a comfortable working angle. (Fig 3)
- The machine can now be used in a push or pull direction.

## Using the Wand attachment. (Fig 4)

- Turn the machine off and lock the handle in the upright position.
- Release the hose from the handle then remove the wand from its housing clip by pulling it backwards and upwards.
- Attach the Round Dusting Brush or Crevice Tool (located on the tool clip) as required.
- Switch the machine on. (Only the vacuum motor will start)
- Ensure the wand and hose are placed firmly back in position after use.

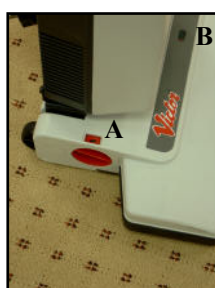

Fig 1



Fig 2

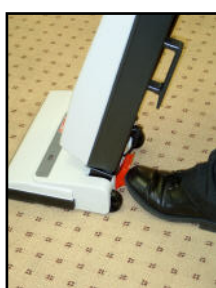

Fig 3



Fig 4

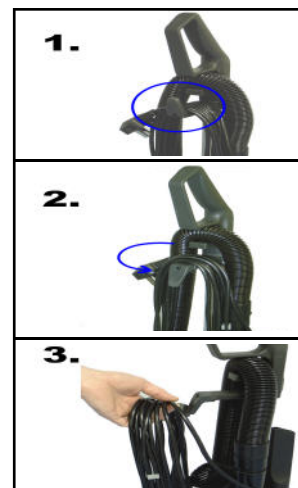

Fig 5

## Dust Bag Full Indicator.

- The bag full indicator light will come on (Fig 2.B) if either the dust collection bag is full or the wand is blocked. (The light comes on when the air flow is obstructed)
- If the light comes on during operation, switch off the machine and check the dust collection bag. If it is full, replace the full bag with a new Victor dust bag. If the bag is not full, check the wand for blockages.

## Warning Light (Fig 1.B)

- GREEN = Brush is working correctly.
- RED = Brush has stopped rotating (see Circuit Breaker section)

## SAFETY INFORMATION

- This machine is designed for DRY USE ONLY.
- This machine should only be used by trained operators.
- Do not use this machine unless it is in a safe condition. Check the cable and plug for damage before use, and if necessary, replace with a new cable pack.  
**NOTE: Only use VICTOR approved cable from our agents or direct.**
- Always pay attention to the cable and keep it away from the brush. Hazard may occur if machine runs over power supply cord.
- Always work within the cable length to avoid cable stress or damage.
- This machine has been designed for use with the brush supplied by the manufacturer. The fitting of other Brushes may effect its safety.
- Check that the voltage shown on the serial number plate is suitable for the supply available.
- This machine is fitted with an anti-static eliminator.
- Always turn off machine when not in use.
- Do not leave machine in the upright position with both motors running.

## THIS VACUUM IS FITTED WITH A CIRCUIT BREAKER

If the Brush Motor overloads, the machine will cut out. If this happens, turn machine off and unplug at mains. Ensure that the brush is not being obstructed by any debris. Wait for a few seconds and restart the machine.

**IMPORTANT:** Wires in the mains lead are coloured in accordance with the following code:  
Blue = Neutral  
Brown = Live

As the colours of the wires in the mains lead of this appliance may not correspond with the coloured markings identifying the terminals in your plug, proceed as follows:

- The wire which is coloured Blue must be connected to the terminal which is marked with the letter N or coloured Black.
- The wire which is coloured Brown must be connected to the terminal which is marked with the letter L or coloured Red.